



2020

Seikei University Short Stay Japanese Program

**WELCOME
TO
SEIKEI UNIVERSITY!**

Program Schedule

2020 / Tuesday, May 26th — Wednesday, June 10th

Capacity

20 students

Qualification

Those who are currently enrolled as full-time degree-seeking students in a university with a student-exchange agreement with Seikei University.

Program Fee

JPY 130,000

This price includes tuition, texts, accommodation and field trips.

Flights, overseas insurance, transportation and meals are NOT included.

Note :

Seikei University accepts **Japanese Yen only**.

Overseas bank transfer fees are NOT included in this price. The applicant or their home university have to cover additional overseas remittance fees and other service charges at the local and main bank in their home country.

Application

Submit the following documents to your University/College office **by Saturday, February 29th, 2020.**

- 1) Application Form
- 2) One ID Photo (*face-to-shoulder photo without background
(in size 4cm × 3cm) . Photo data (J-Peg etc) is acceptable.
http://www.immi-moj.go.jp/english/tetuduki/zairyuu/photo_info.html
- 3) Academic Transcript
- 4) Copy of Passport
- 5) Certificate of Japanese Language Proficiency (*Not required, but desirable)

[NOTE] Since there are only limited number of rooms at the International House, we highly recommend that you make an application as early as possible.



About the Program

This two-week intensive program is aimed at students who are currently enrolled at our partner universities and are studying the Japanese language. The program consists of Japanese language classes and cultural experience activities. The classes will be decided according to the Japanese language levels of the participants.

1. Beginner Class

This class is mainly for those who have little or no previous experience of learning Japanese.

2. Elementary Class

This class is mainly for those who have learned Japanese to an advanced beginner or lower intermediate level and can understand simple phrases and texts in familiar everyday situations.

Those students who have skills equivalent to the JLPT (Japanese Language Proficiency Test) N4 – N5 levels are best suited to this class.

Each class is designed to improve the practical Japanese skills of the participants. The course content is related to the cultural experience classes. Japanese students will also join the program as PA (Program Assistants) and support the participants' study and campus life during the program.

Activities

We will also offer various activities, such as field trips, cultural excursions and parties organized by Seikei students. The costs for these activities are included in the program fee.



Program Schedule

Seikei University Summer Short Programme 2020

	5月24日 Sun	5月25日 Mon	5月26日 Tue	5月27日 Wed	5月28日 Thu	5月29日 Fri	5月30日 Sat
AM 8:50-10:30 10:40-12:20			チェックイン Check-in	オリエンテーション Orientation	日本語授業 Japanese Language Class	日本語授業 Japanese Language Class	フリー Free
PM 13:10-14:50 15:00-16:40				歓迎式 キャンパスツアー Welcome Ceremony Campus Tour	文化体験 (江戸東京たてもの園) Cultural Activity (Edo-Tokyo Architectual Museum)	フリー Free	フリー Free

	5月31日 Sun	6月1日 Mon	6月2日 Tue	6月3日 Wed	6月4日 Thu	6月5日 Fri	6月6日 Sat
AM 8:50-10:30 10:40-12:20		日本語授業 Japanese Language Class	日本語授業 Japanese Language Class	日本語授業 Japanese Language Class	日本語授業 Japanese Language Class	日本語授業 Japanese Language Class	バスツアー (富士山) Bus Tour (Mt. Fuji)
PM 13:10-14:50 15:00-16:40		フリー Free	文化体験 (渋谷、原宿、明治神宮) Cultural Activity (Shibuya, Harajuku, Meiji Shrine)	フリー Free 多読(自由参加) Extensive Reading	日本文化講義 (ジブリアニメ) Japanese Culture Class (Ghibli Animation)	文化体験 (ジブリ美術館) Cultural Activity (Ghibli Museum)	

	6月7日 Sun	6月8日 Mon	6月9日 Tue	6月10日 Wed	6月11日 Thu	6月12日 Fri	6月13日 Sat
AM 8:50-10:30 10:40-12:20		日本語授業 Japanese Language Class	日本語授業 Japanese Language Class	チェックアウト Check-out			
PM 13:10-14:50 15:00-16:40		フリー Free	修了式 お別れ会 Closing Ceremony Farewell Party				

About Seikei University

Seikei University was founded in 1912 and has a long tradition of international students.

About 30 international students are currently enrolled at Seikei, where they study Japanese and faculty-delivered courses.

The International Office of Seikei University is experienced in providing assistance to students from diverse backgrounds, enhancing their campus life at Seikei.

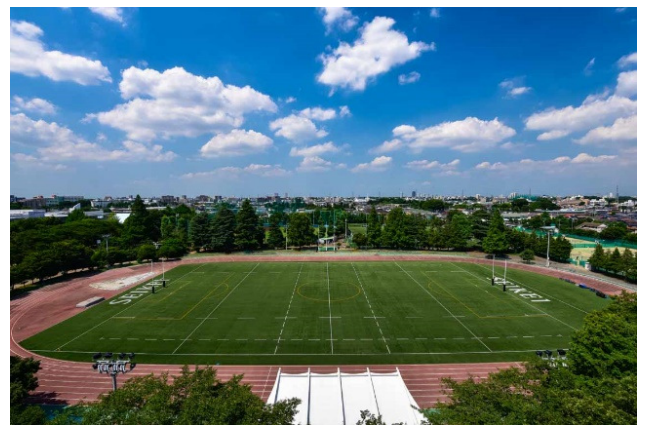

About Kichijoji

Seikei University is located in Kichijoji in Tokyo.

Kichijoji is considered to be the most desirable area to live in Tokyo, with good access to both Shinjuku and Shibuya.

There are many attractive local places such as cafes, restaurants, museums and theaters, as well as plenty of shopping outlets.

The participants in the Program are strongly encouraged to go into Kichijoji and practice the Japanese they have learned in their classes. It is also a good opportunity to experience the vibrant lifestyle of the area.



Inokashira Park

One of the most popular places in Kichijoji is Inokashira Park, one of the largest parks in Tokyo.

It covers a vast space with luscious greenery and is loved by both locals and tourists alike.

At one end of the park is the Ghibli Museum, where fans of the films visit from all over the world.



Accommodation

The International House (Kokusai Koryu Kaikan)

Seikei University will accommodate participants at the International House (Kokusai Kouryu Kaikan), the on-campus dormitory.

The student units of the International House are intended for single residency.

Available dates: **Tuesday, May 26th to Wednesday, June 10th**

*The participants are allowed to extend their stay at the International House until **Saturday, June 13th**.

In this case, the cost is JPY2,000 (including utility charges) per night.

Address: 3-6-35 Kichijoji-kitamachi, Musashino-shi, Tokyo, 180-0001

Student unit: 20 m² (furnished, with private bathroom and terrace)

Rent: Included in the program fee.

Utility charges (gas, water and electricity): Included in the program fee.

Fees: washer & dryer

Meals: No meals are provided. A shared kitchen is located on each floor.

Guest accommodation: Not available.

Furnishings:

Single Unit for Students.

Bath, single bed with linen, wardrobe, desk & chair, drawers, chest, bookshelf, trash can, shoe box, air conditioner, Wi-Fi, TV outlet, computer outlet (connected to campus LAN), utility meters.

Lounge

Tables and chairs, leather couches, a service board, a piano, two bookshelves.

Terrace

Garden tables & chairs

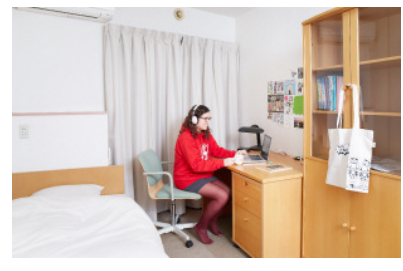

University Facilities

Library

The participants are provided with student ID cards and will have access to the University library.

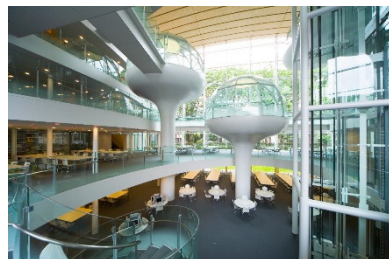

Wi-Fi

A student ID and password to log in the on-campus network will be provided to the participants

Insurance

All participants must have travel insurance that provides cover for the entire duration of their study and travel. This should cover unexpected medical emergencies and hospitalizations, damage to property, canceled trips and delayed flights, as well as lost luggage.

NOTICE:

- The program may be canceled if the number of participants fails to reach the minimum number.
- The program schedule may be subject to change.
- Personal information that the applicants provide will be used only for registration and management for the program.
- Cancellation charge may arise if the applicant cancel his/her participation in the program after the payment of the tuition.

